



# DOSATRON®

An Ingersoll Rand Business



## D25RE2-IE - 11 GPM ESQUEMAS INTERACTIVOS

### ESPECIFICACIONES

- 1:500 - 1:50
- 4.3 - 85 PSI
- Conexión 3/4" NPT

### RECOMENDACIONES

- Filtro de malla de 200/80 micrones antes de la unidad

### MANTENIMIENTO

- Mini Kit de Mantenimiento  
Parte #: **PJ117MINI-H**  
para mantenimiento regular
- Kit de Empaques  
Parte #: **PJ135**  
para mantenimiento anual
- Kit Renovación  
Parte #: **MKD25RE2**  
extiende la vida de su unidad

### INSTRUCCIONES

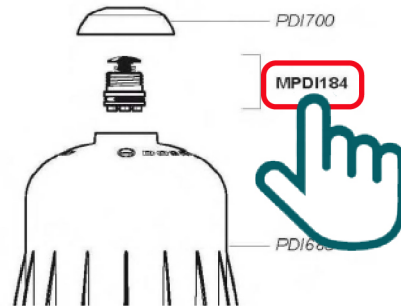

- Haga clic en el # de parte, para visitar la página
- Regrese a este documento con la flecha



# D25RE2-IE

2.5 m<sup>3</sup>/h - 0.2 - 2%  
11 GPM - 1:500 - 1:50  
0.3 - 6 bar  
4.3 - 85 psi

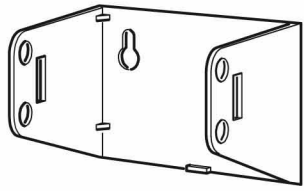
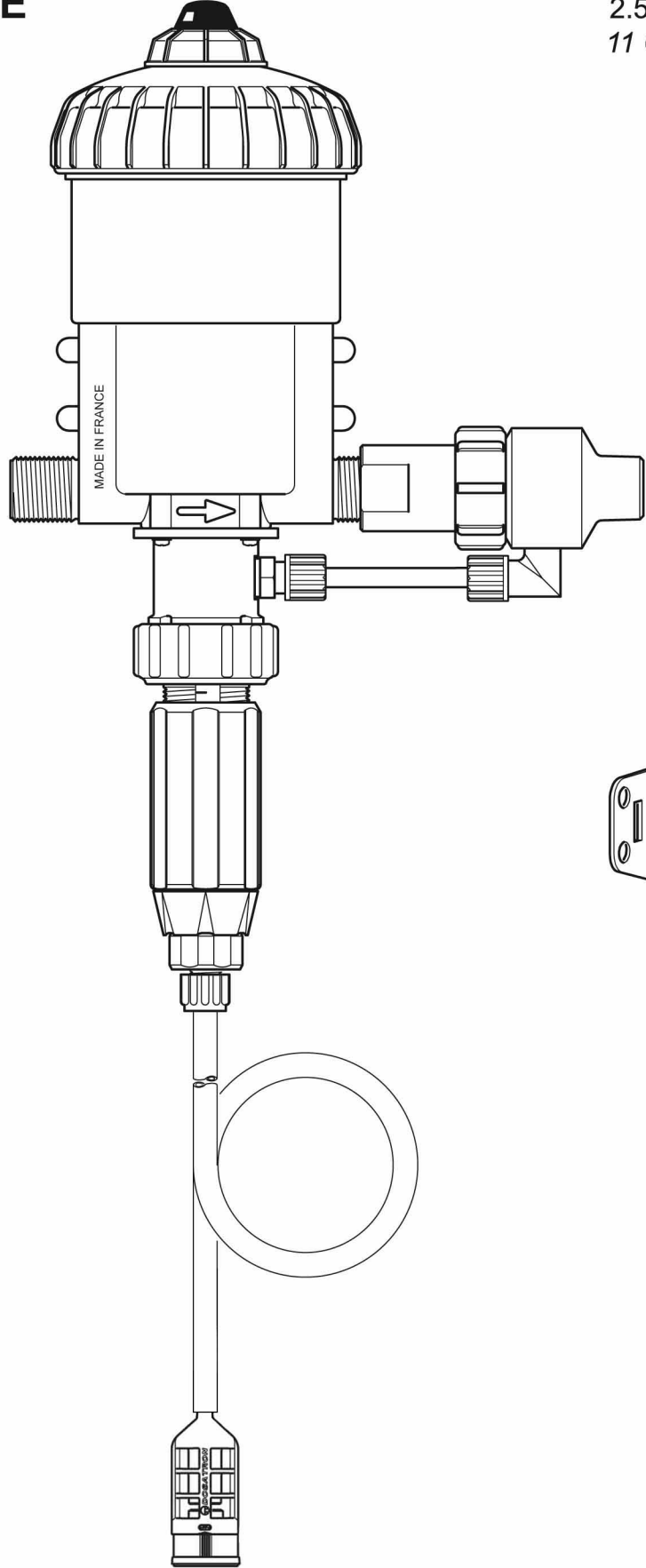

# D25RE2-IE

2.5 m<sup>3</sup>/h - 0.2 - 2%  
11 GPM - 1:500 - 1:50  
0.3 - 6 bar  
4.3 - 85 psi

**C+M**

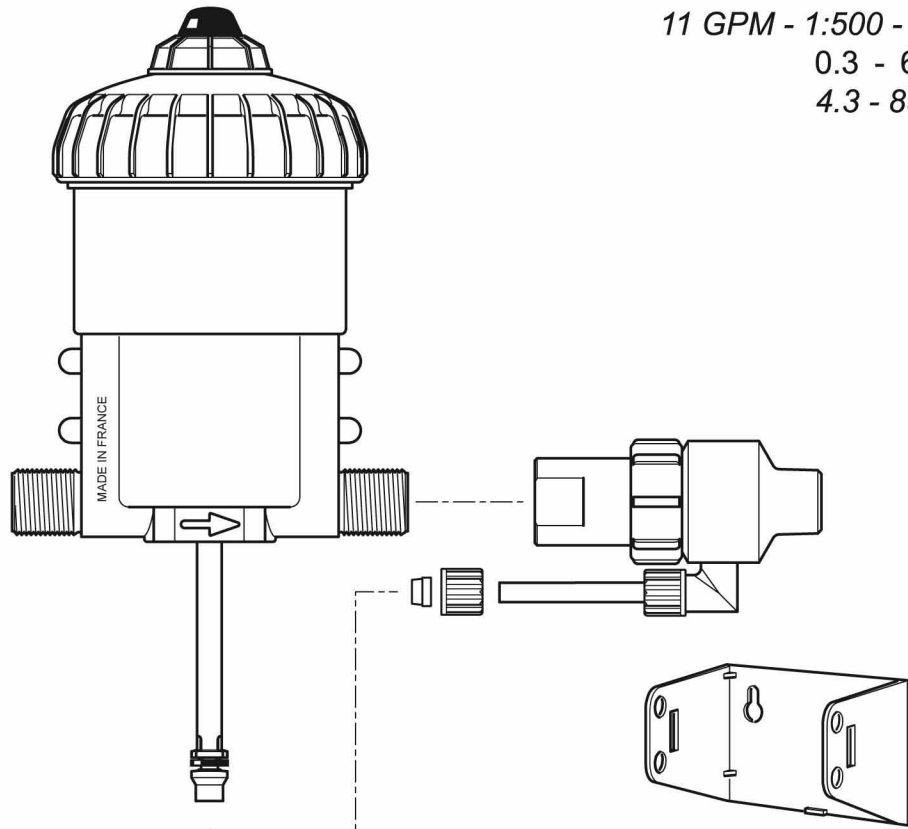

**A**

**D+IE**

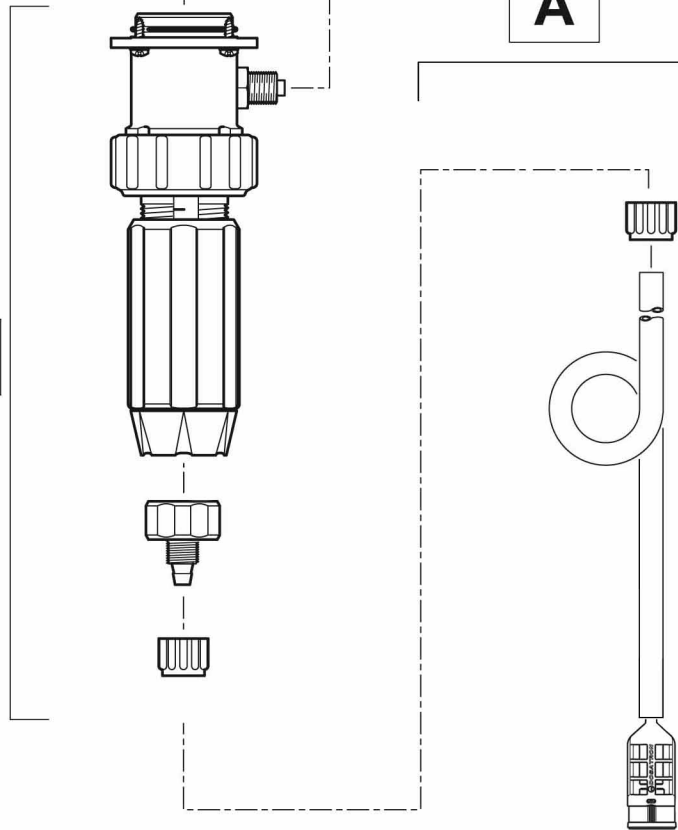

# D25RE2-IE

2.5 m<sup>3</sup>/h - 0.2 - 2%  
 11 GPM - 1:500 - 1:50  
 0.3 - 6 bar  
 4.3 - 85 psi

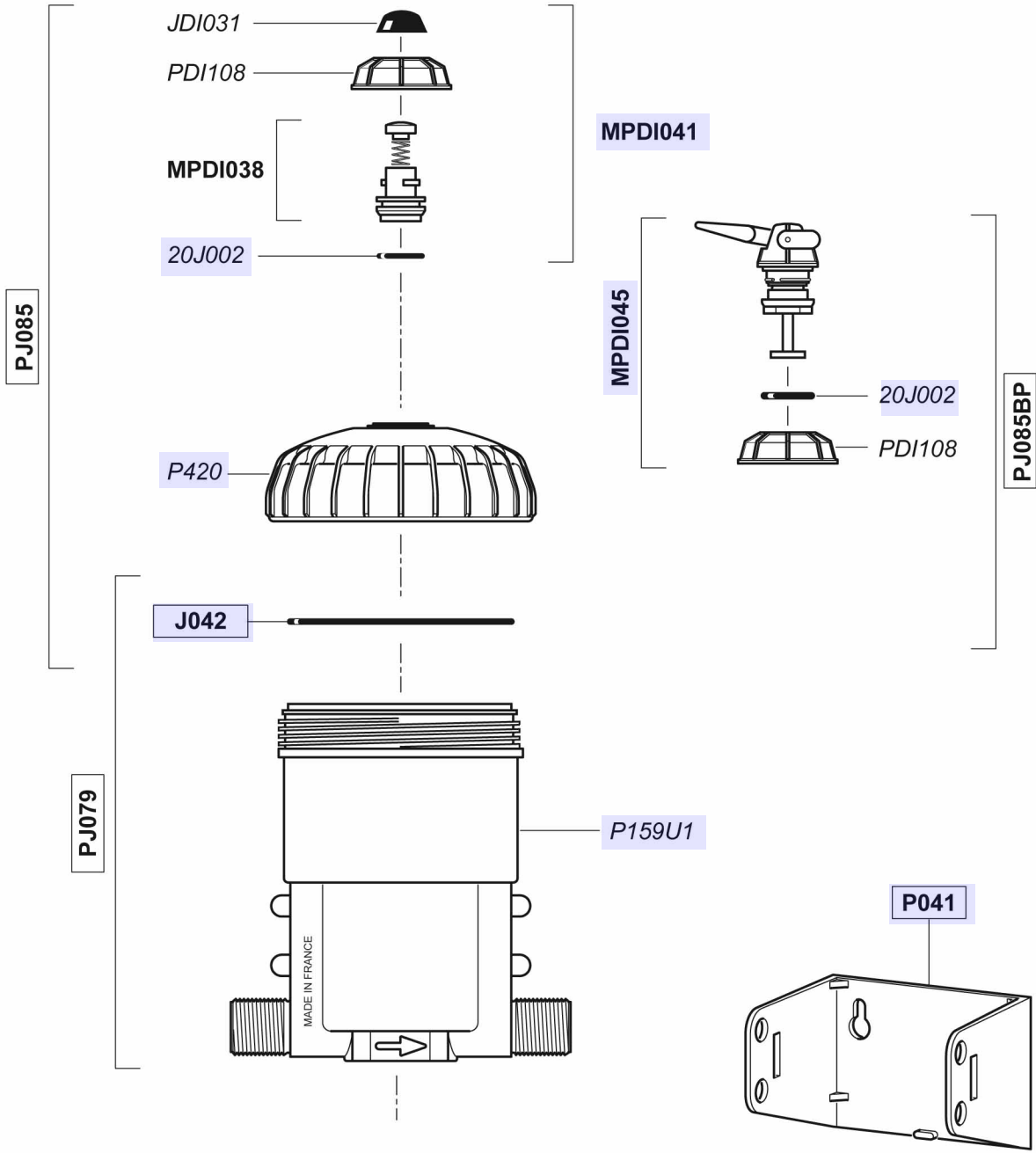

© DOSATRON INTERNATIONAL S.A. 2007  
 D25RE2-IE/01/07/D3



# D25RE2-IE

2.5 m<sup>3</sup>/h - 0.2 - 2%  
11 GPM - 1:500 - 1:50  
0.3 - 6 bar  
4.3 - 85 psi

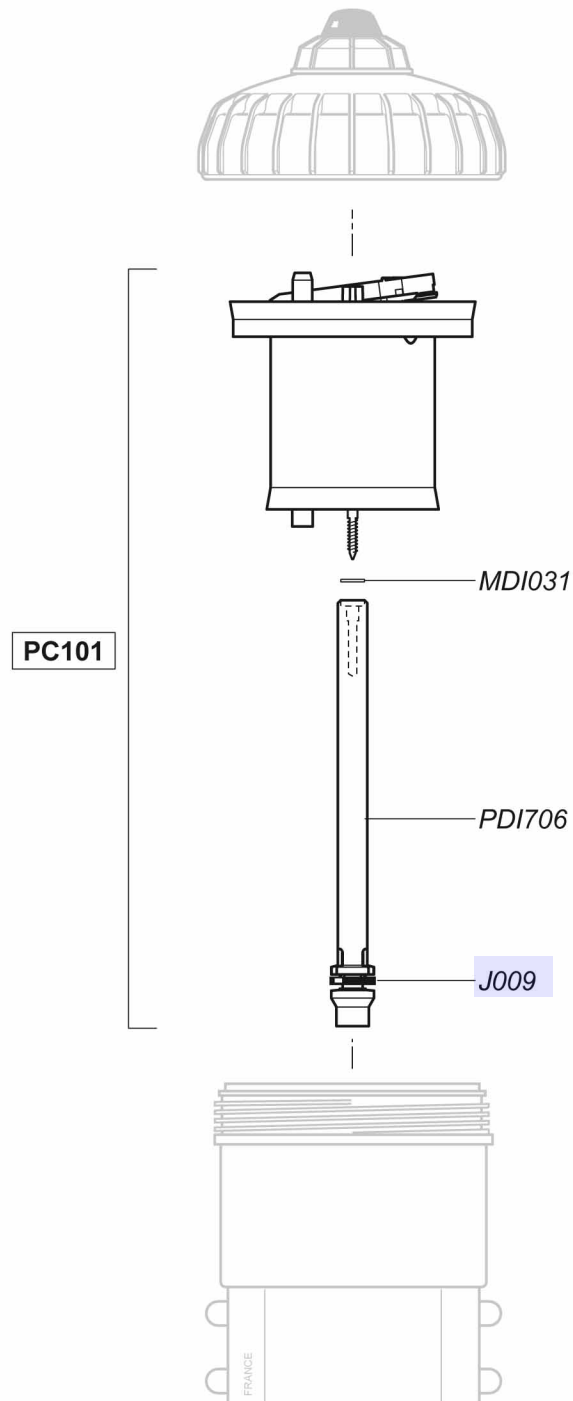

# D25RE2-IE

2.5 m<sup>3</sup>/h - 0.2 - 2%  
11 GPM - 1:500 - 1:50  
0.3 - 6 bar  
4.3 - 85 psi

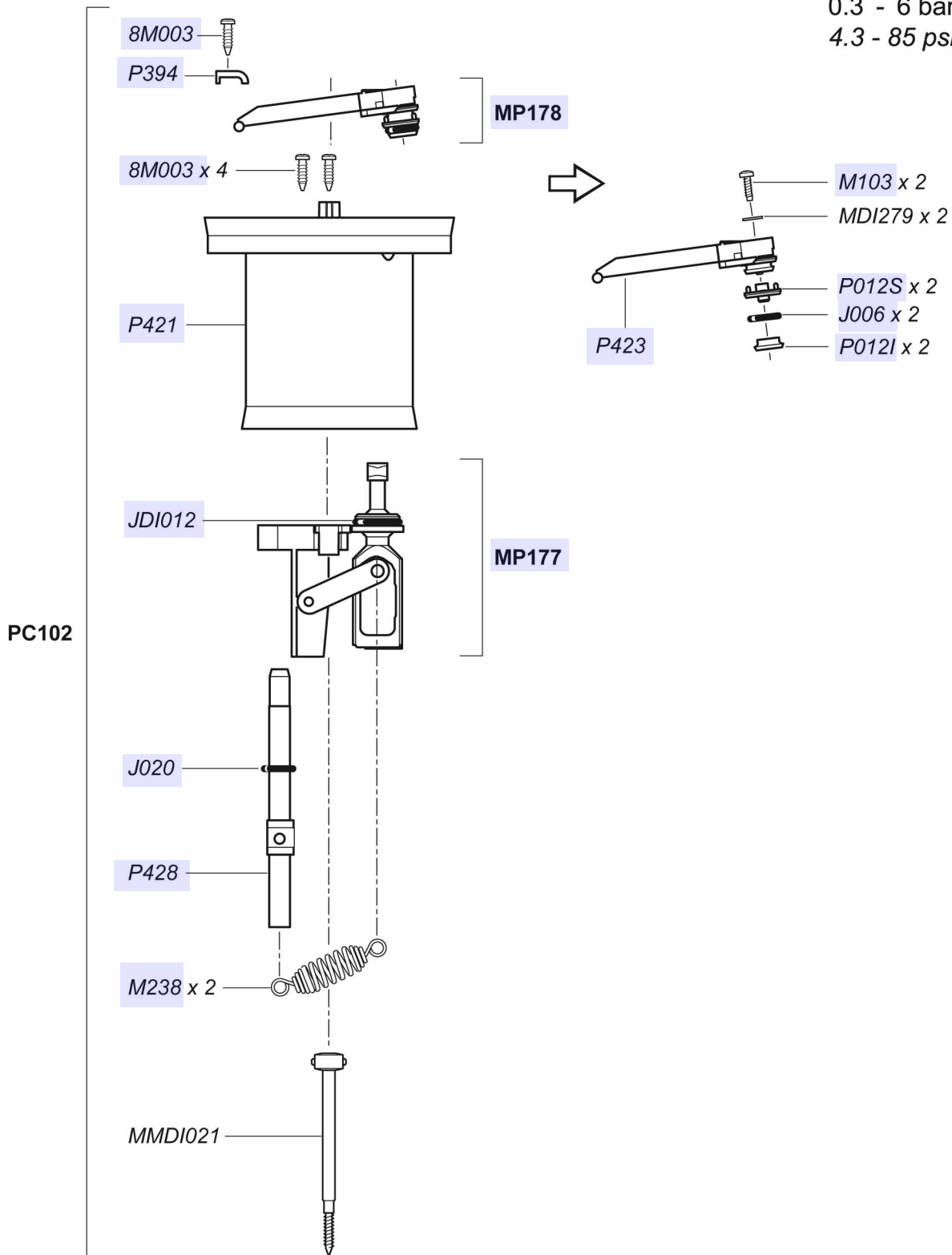

# D25RE2-IE

2.5 m<sup>3</sup>/h - 0.2 - 2%  
11 GPM - 1:500 - 1:50  
0.3 - 6 bar  
4.3 - 85 psi

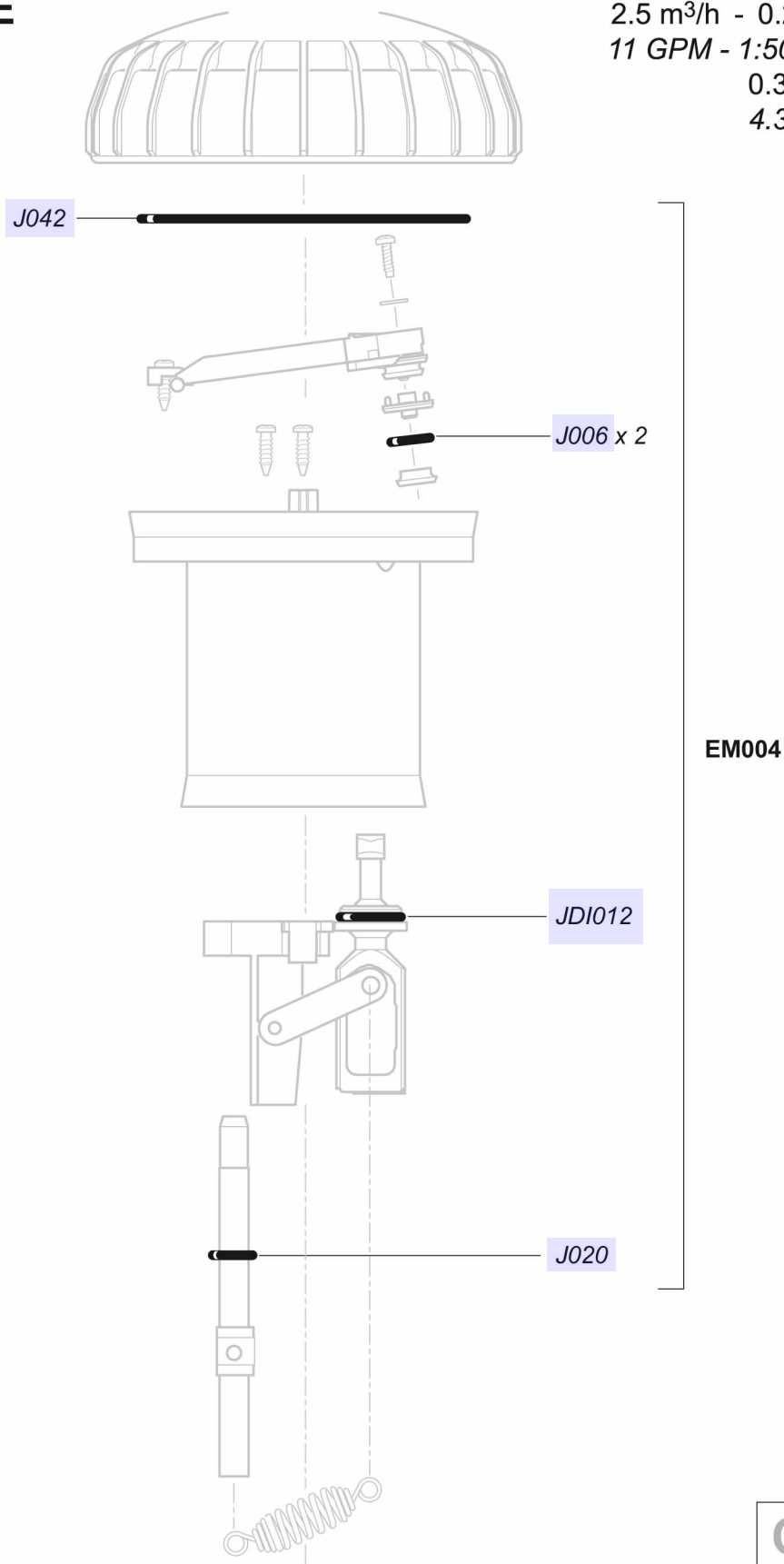

# D25RE2-IE

2.5 m<sup>3</sup>/h - 0.2 - 2%  
 11 GPM - 1:500 - 1:50  
 0.3 - 6 bar  
 4.3 - 85 psi

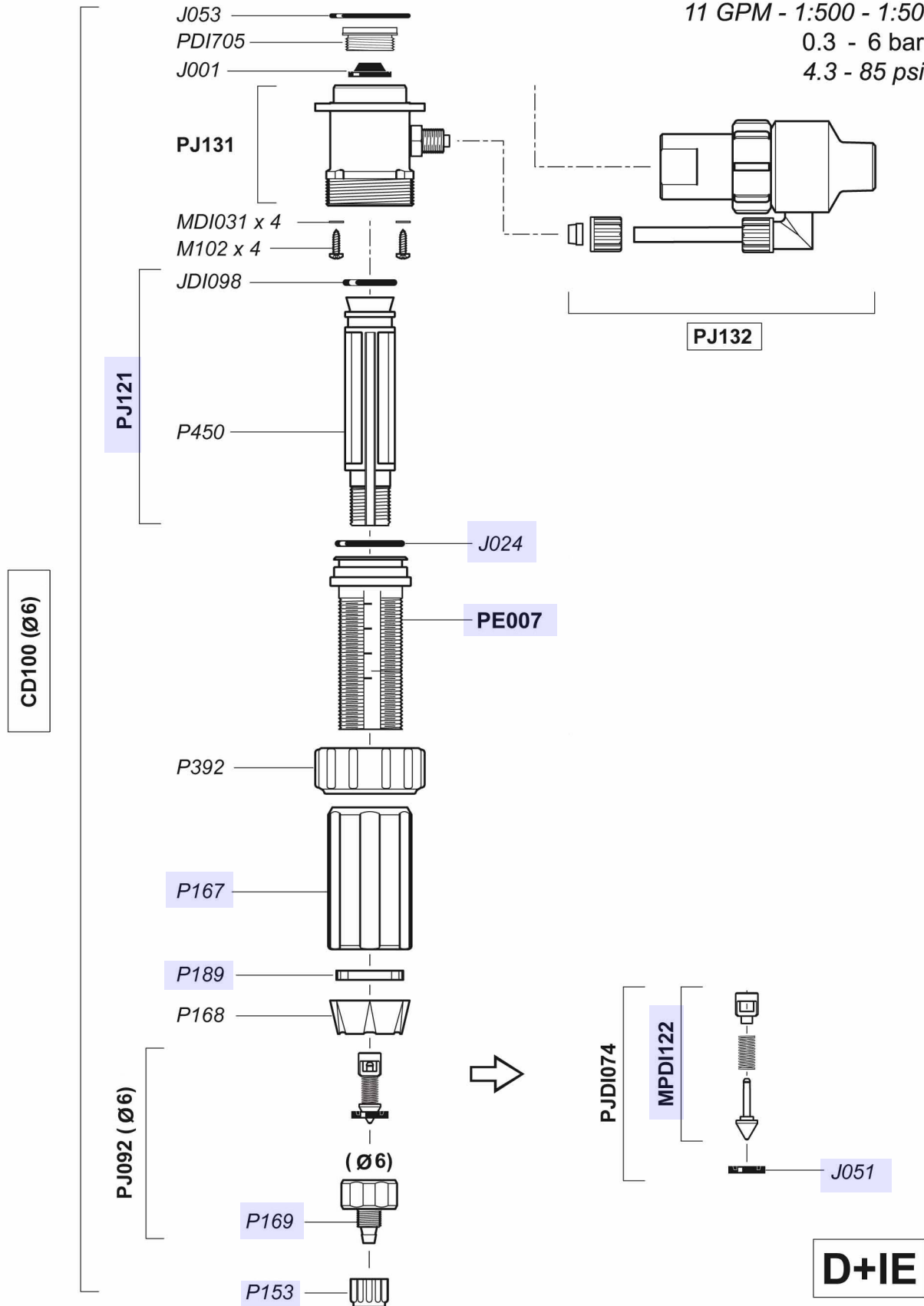



# D25RE2-IE

2.5 m<sup>3</sup>/h - 0.2 - 2%  
11 GPM - 1:500 - 1:50  
0.3 - 6 bar  
4.3 - 85 psi

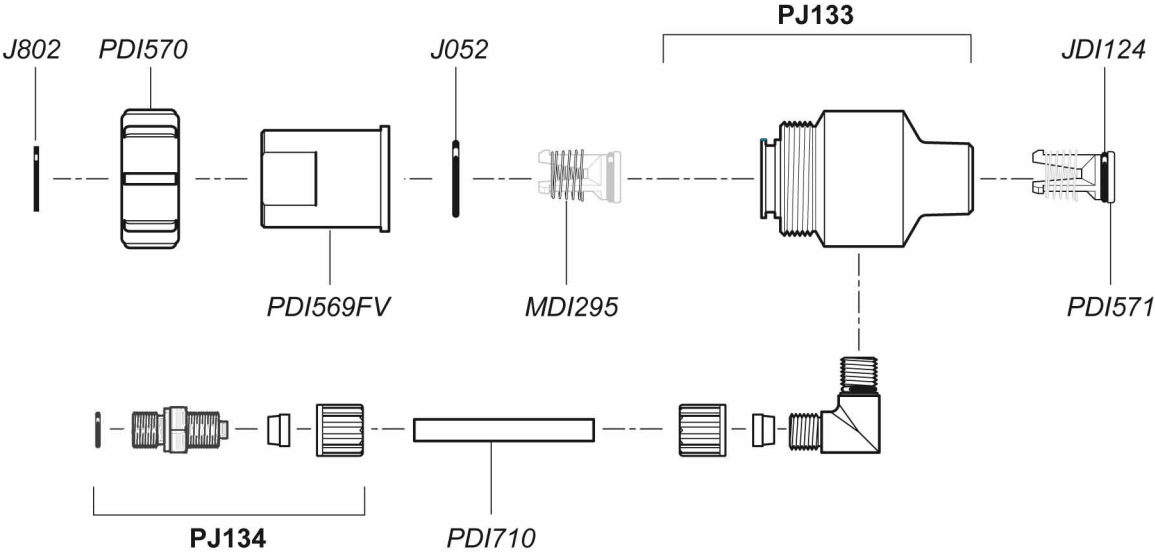
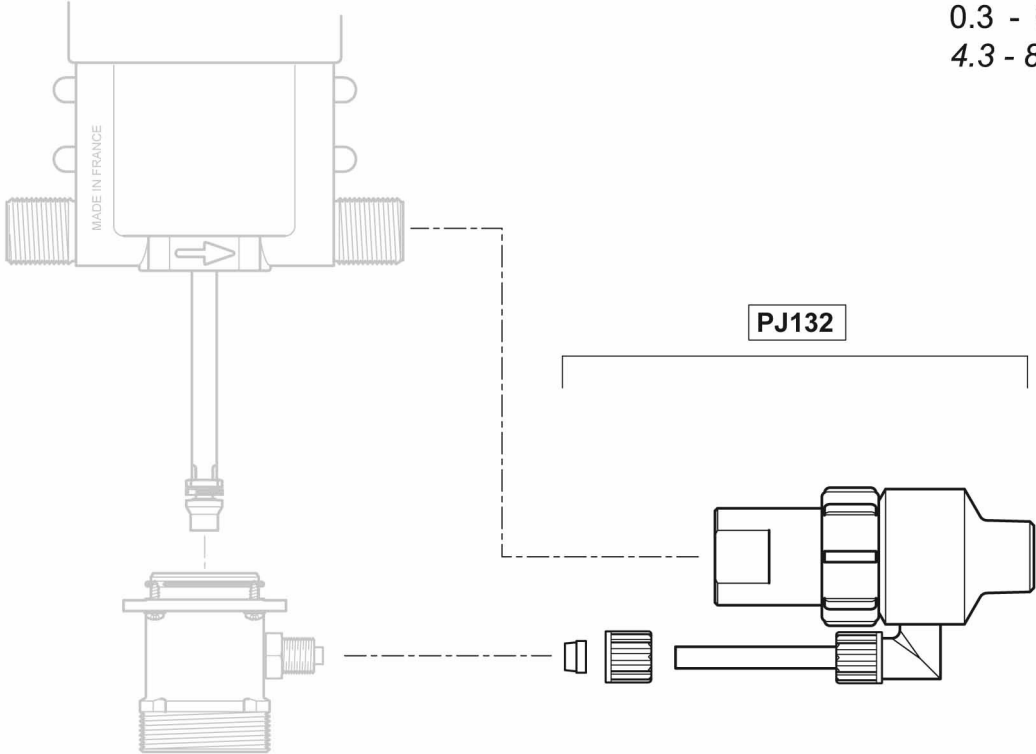

**D+IE**

# D25RE2-IE

2.5 m<sup>3</sup>/h - 0.2 - 2%  
11 GPM - 1:500 - 1:50  
0.3 - 6 bar  
4.3 - 85 psi

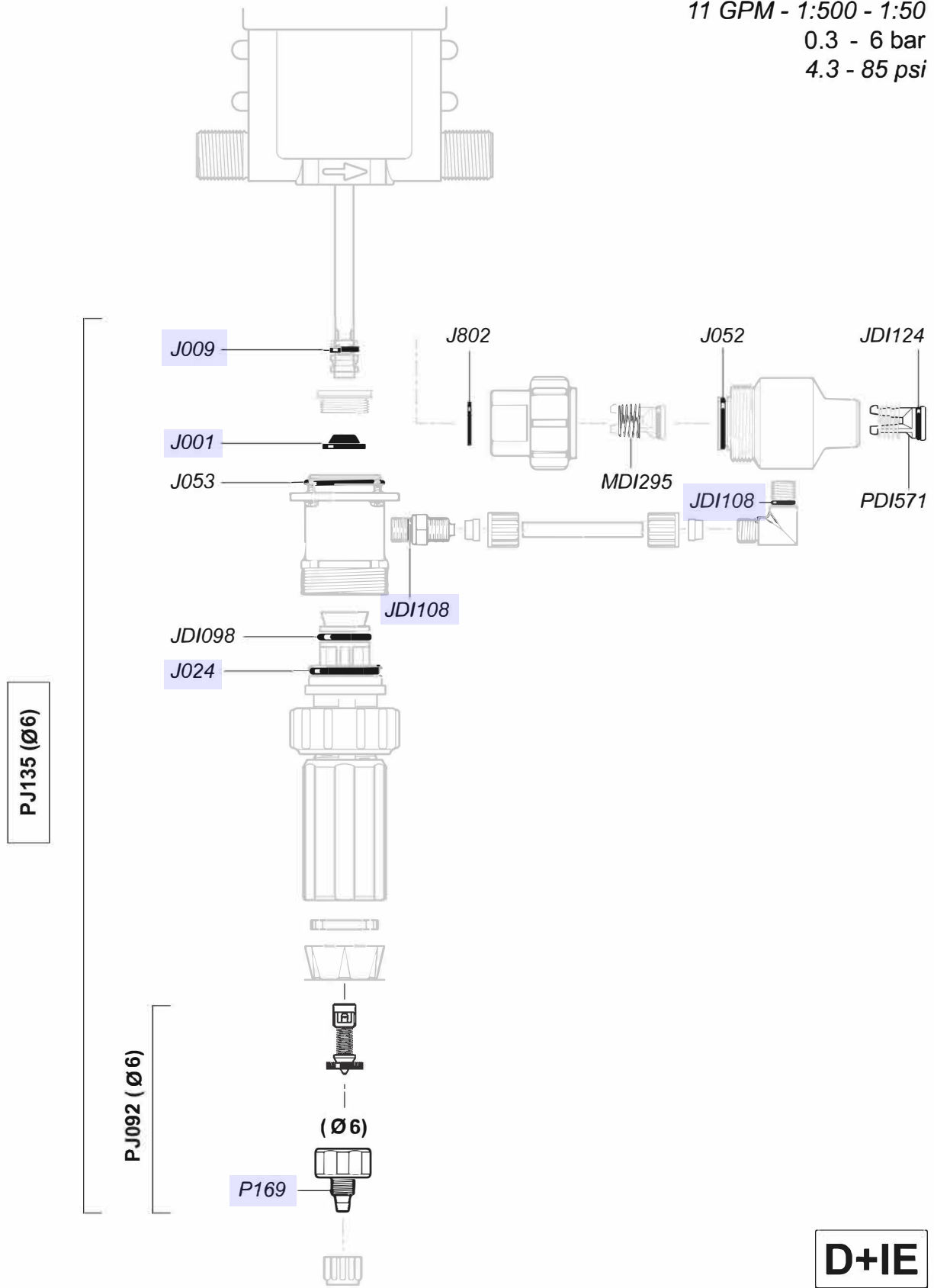

# D25RE2-IE

2.5 m<sup>3</sup>/h - 0.2 - 2%  
11 GPM - 1:500 - 1:50  
0.3 - 6 bar  
4.3 - 85 psi

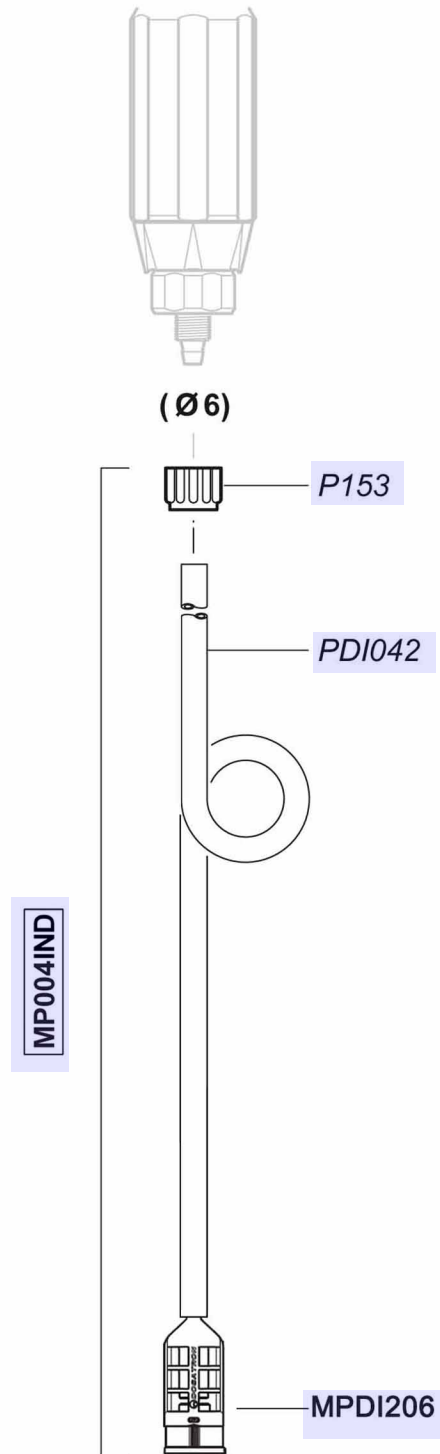

© DOSATRON INTERNATIONAL S.A. 2007  
D25RE2-IE/01/07/D10

**A**