



DOSATRON®

WATER POWERED DOSING TECHNOLOGY

D45RE8-IE

D45RE8-IE

4.5 m³/h - 3 - 8%
20 GPM - 1:33 - 1:13
0.5 - 5 bar
7 - 70 psi

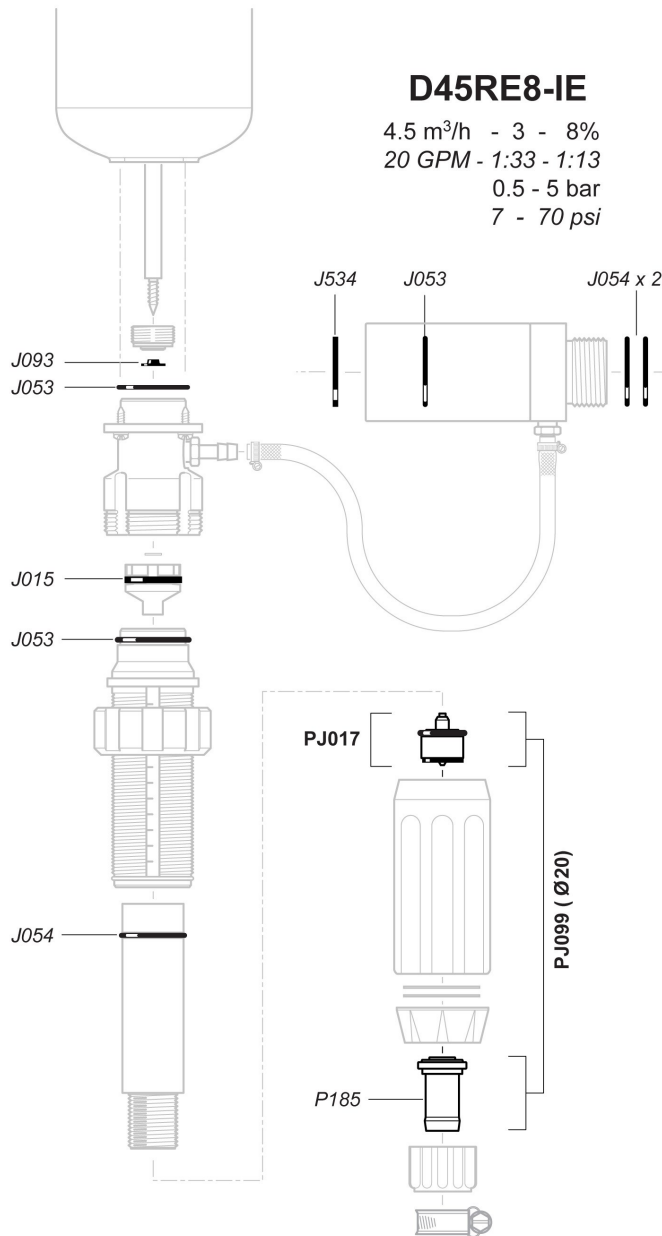

PJ100



Part # PJ150

Injection Seal Kit

**D45RE8-IE
(20 GPM
Side-Inject Unit)**

**D45RE8-IE
Side-Inject
1:33 to 1:12
3% to 8%**

**GENUINE
DOSATRON
PARTS**

**Routine Maintenance once a year will add to the
life of your Dosatron! Register your unit at:
www.dosatronusa.com/resources**

**Call 1-800-523-8499
For Technical Support**



DOSATRON®

WATER POWERED DOSING TECHNOLOGY

2090 Sunnydale Blvd. Clearwater, FL 33765 USA
Tel: 1-727-443-5404 • Fax: 1-727-447-0591
Service 1-800-523-8499 • www.dosatronusa.com



DOSATRON®

WATER POWERED DOSING TECHNOLOGY

D45RE8-IE

D45RE8-IE

4.5 m³/h - 3 - 8%
20 GPM - 1:33 - 1:13
0.5 - 5 bar
7 - 70 psi

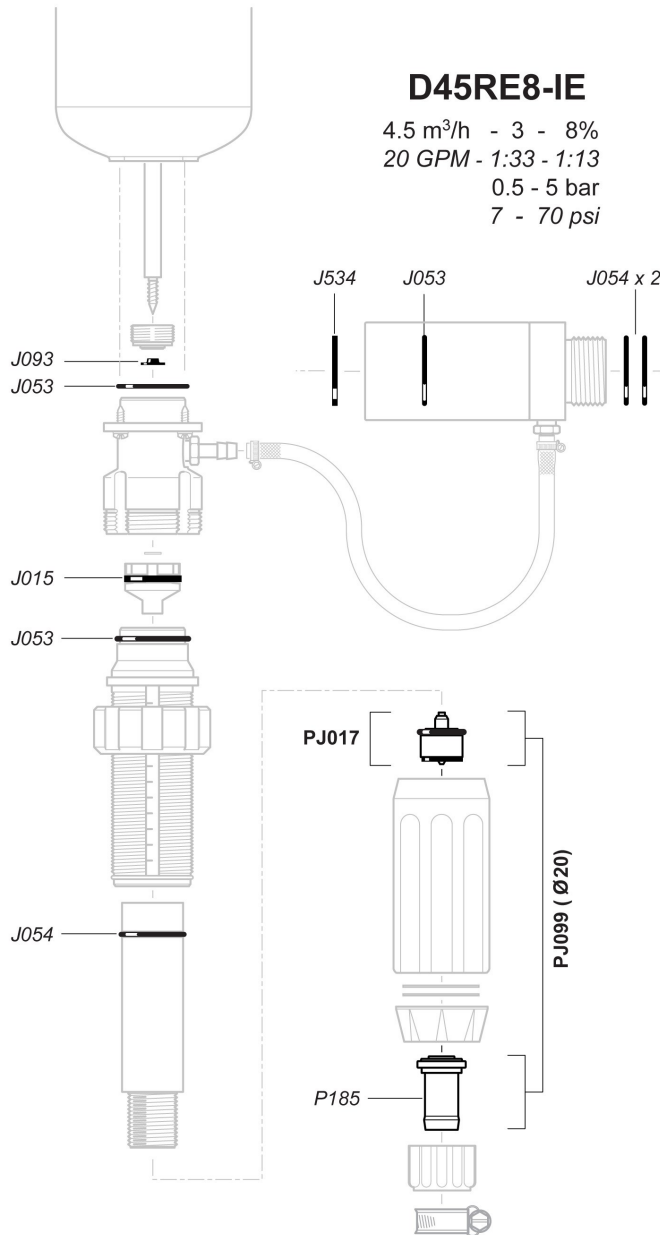

Part # PJ150

Kit de Empaques

**D45RE8-IE
(20 GPM
Inyección Lateral)**

**D45RE8-IE
Inyección Lateral
1:33 to 1:12
3% to 8%**

**GENUINE
DOSATRON
PARTS**

Para participar en el programa de mantenimiento preventivo registre su dosificador en:
www.dosatronusa.com/resources

**Llámenos +1-727-443-5404
Para Servicio Técnico**



DOSATRON®

WATER POWERED DOSING TECHNOLOGY

2090 Sunnydale Blvd. Clearwater, FL 33765 USA
Tel: 1-727-443-5404 • Fax: 1-727-447-0591
Service 1-800-523-8499 • www.dosatronusa.com