

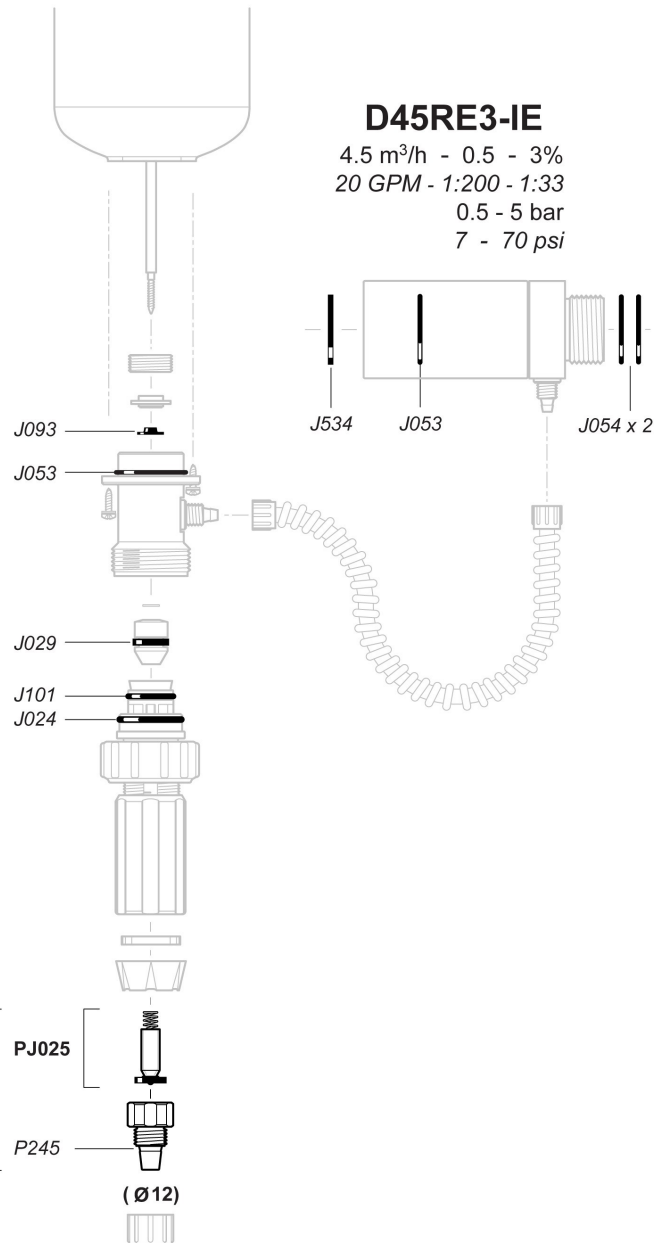

DOSATRON®

WATER POWERED DOSING TECHNOLOGY

D45RE3-IE



PJ095



Part # PJ095

Injection Seal Kit

**D45RE3-IE
(20 GPM
Side-Inject Unit)**

**D45RE3-IE
Side-Inject
1:200 to 1:33
0.5% to 3%**

**GENUINE
DOSATRON
PARTS**

**Routine Maintenance once a year will add to the
life of your Dosatron! Register your unit at:
<https://www.dosatronusa.com/resources/>**

**Call 1-800-523-8499
For Technical Support**



DOSATRON®

WATER POWERED DOSING TECHNOLOGY

2090 Sunnydale Blvd. Clearwater, FL 33765 USA
Tel: 1-727-443-5404 • Fax: 1-727-447-0591 • Service 1-800-523-8499
www.dosatronusa.com



DOSATRON®

WATER POWERED DOSING TECHNOLOGY

D45RE3-IE

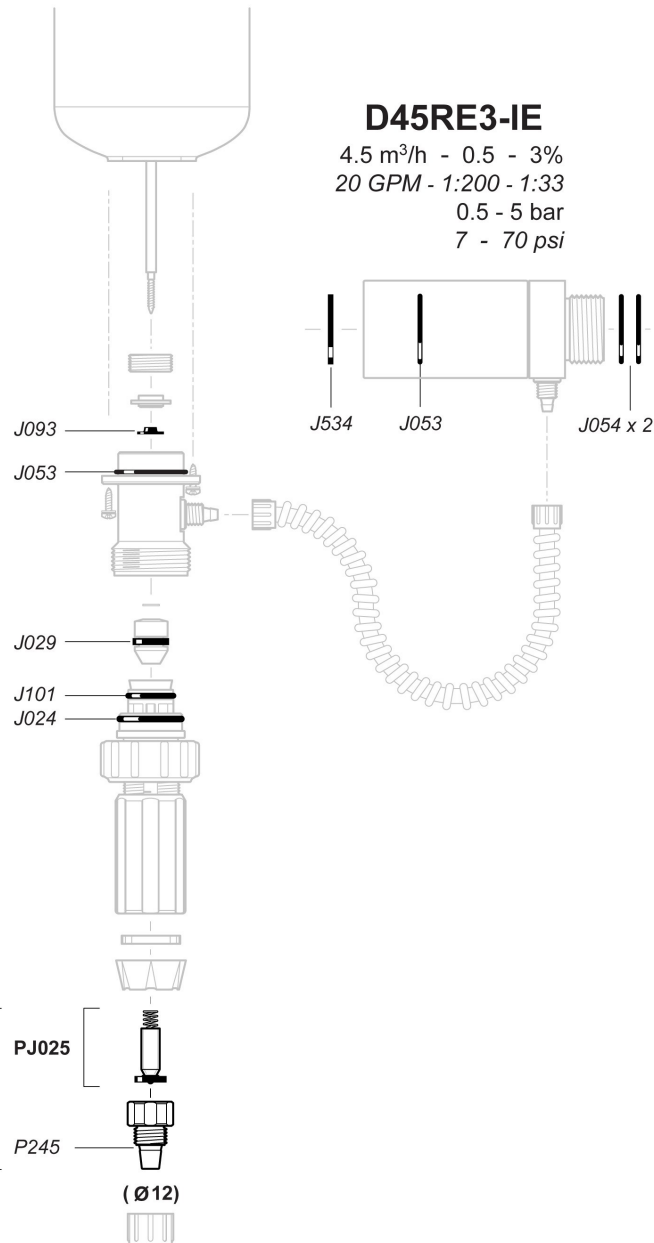

Part # PJ095

Kit de Inyección

**D45RE3-IE
(20 GPM
Inyección lateral)**

**D45RE3-IE
Inyección lateral
1:200 to 1:33
0.5% to 3%**

**GENUINE
DOSATRON
PARTS**

Para participar en el programa de mantenimiento preventivo, registre su dosificador en:
<https://www.dosatronusa.com/resources/>

**Lláme al +1-727-443-5404
Para Soporte Técnico**



DOSATRON®

WATER POWERED DOSING TECHNOLOGY

2090 Sunnydale Blvd. Clearwater, FL 33765 USA
 Tel: 1-727-443-5404 • Fax: 1-727-447-0591 • Service 1-800-523-8499
www.dosatronusa.com