



# DOSATRON®

An Ingersoll Rand Business



## D45RE15-IE - 20 GPM INTERACTIVE SCHEMATICS

### UNIT SPECIFICATIONS

- 1:500 - 1:66
- 7 - 70 PSI
- 1" NPT Connection

### SUGGESTED INSTALLATION

- 200 mesh/80 micron water filter prior to the unit

### DOCUMENT INSTRUCTIONS

- Click on a part #, to visit item page
- Click arrow back from item page, to return to this document

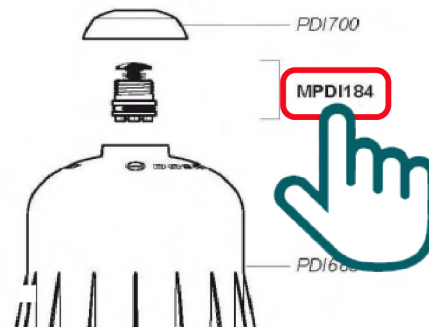

# D45RE1.5-IE

4.5 m<sup>3</sup>/h - 0.2 - 1.5%  
20 GPM - 1:500 - 1:67  
0.5 - 5 bar  
7 - 70 psi

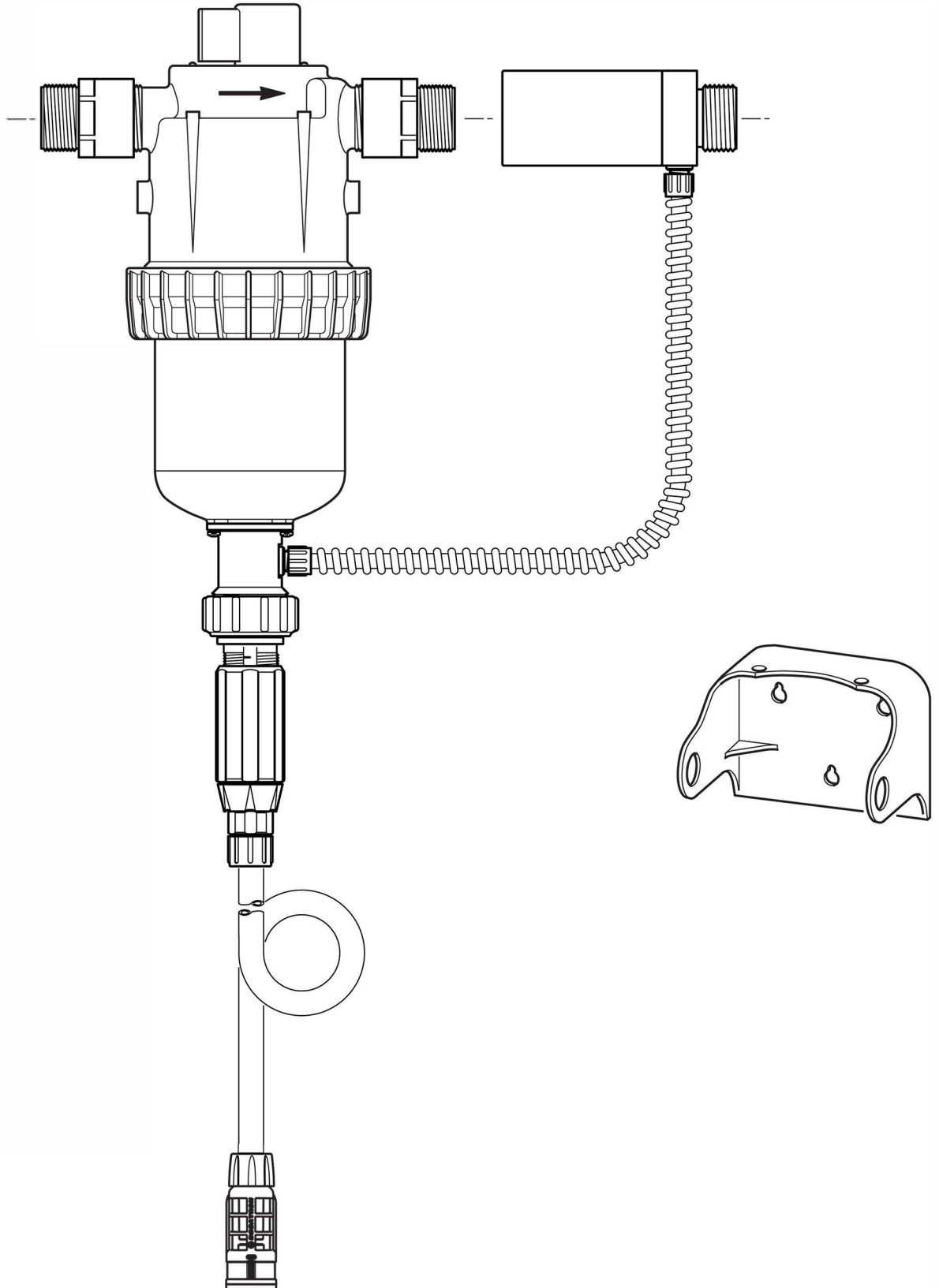

# D45RE1.5-IE

4.5 m<sup>3</sup>/h - 0.2 - 1.5%  
20 GPM - 1:500 - 1:67  
0.5 - 5 bar  
7 - 70 psi

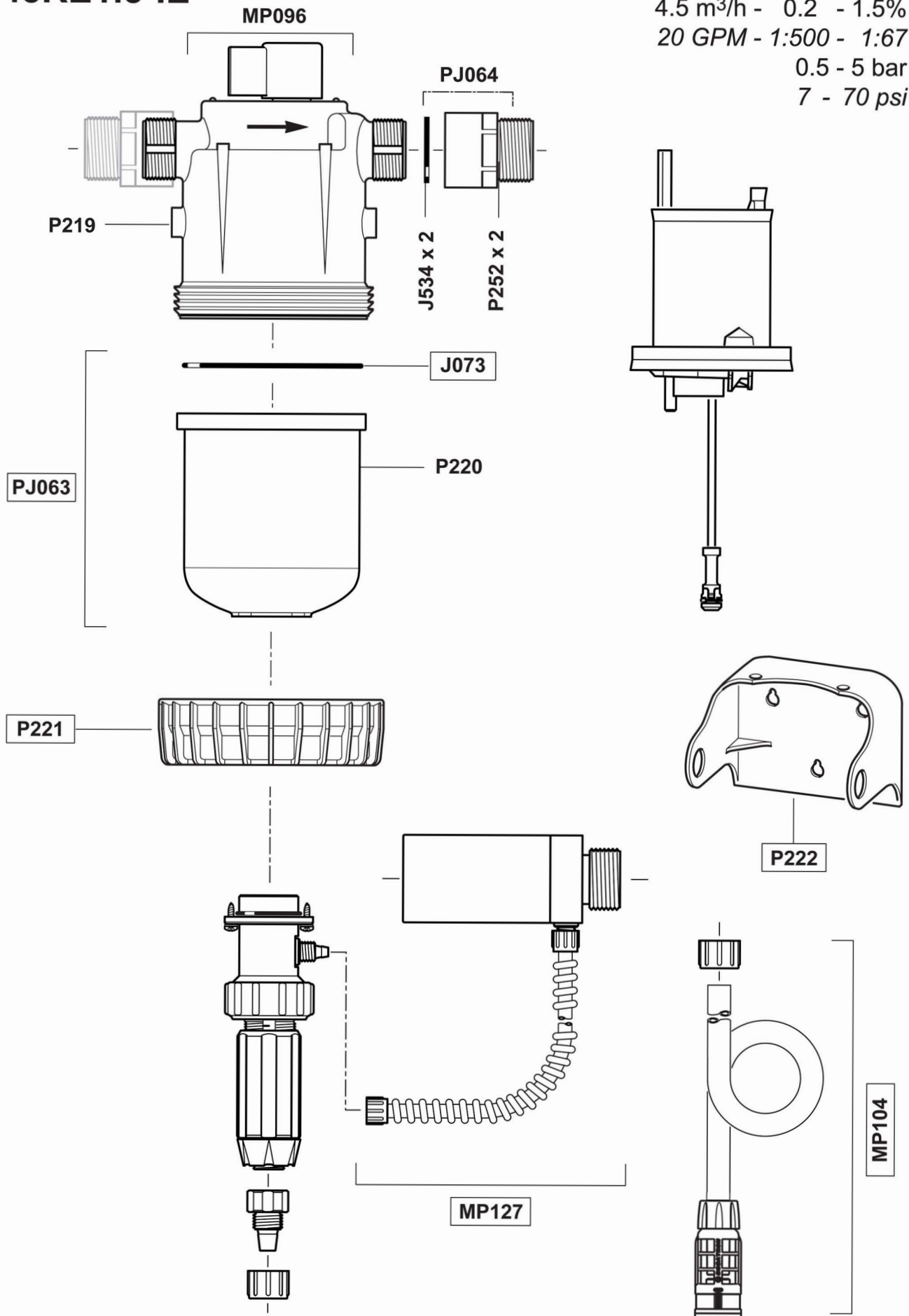

# D45RE1.5-IE

4.5 m<sup>3</sup>/h - 0.2 - 1.5%  
20 GPM - 1:500 - 1:67  
0.5 - 5 bar  
7 - 70 psi

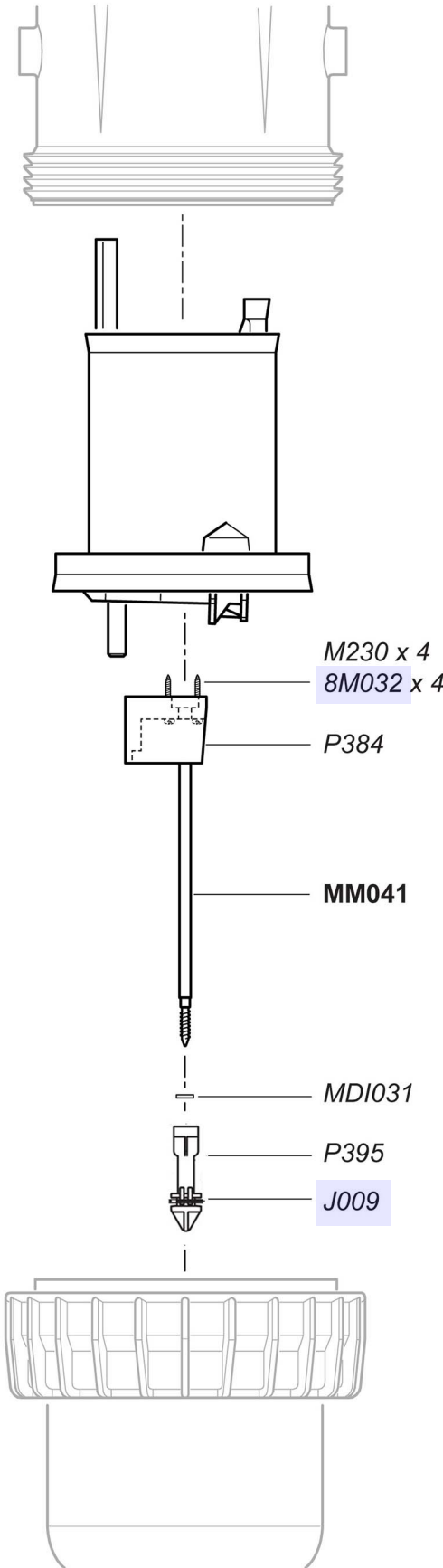

# D45RE1.5-IE

4.5 m<sup>3</sup>/h - 0.2 - 1.5%  
 20 GPM - 1:500 - 1:67  
 0.5 - 5 bar  
 7 - 70 psi

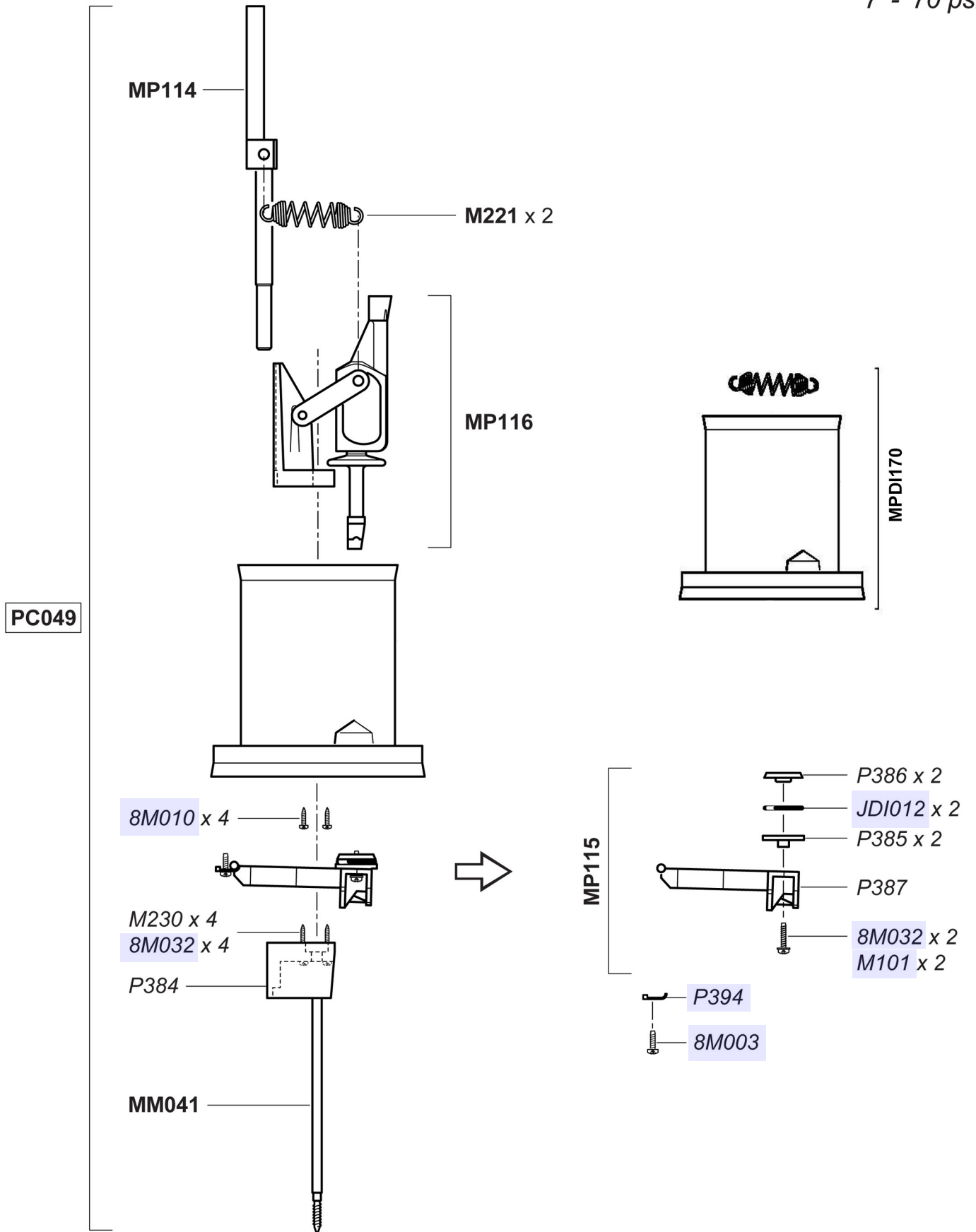

# D45RE1.5-IE

4.5 m<sup>3</sup>/h - 0.2 - 1.5%  
 20 GPM - 1:500 - 1:67  
 0.5 - 5 bar  
 7 - 70 psi

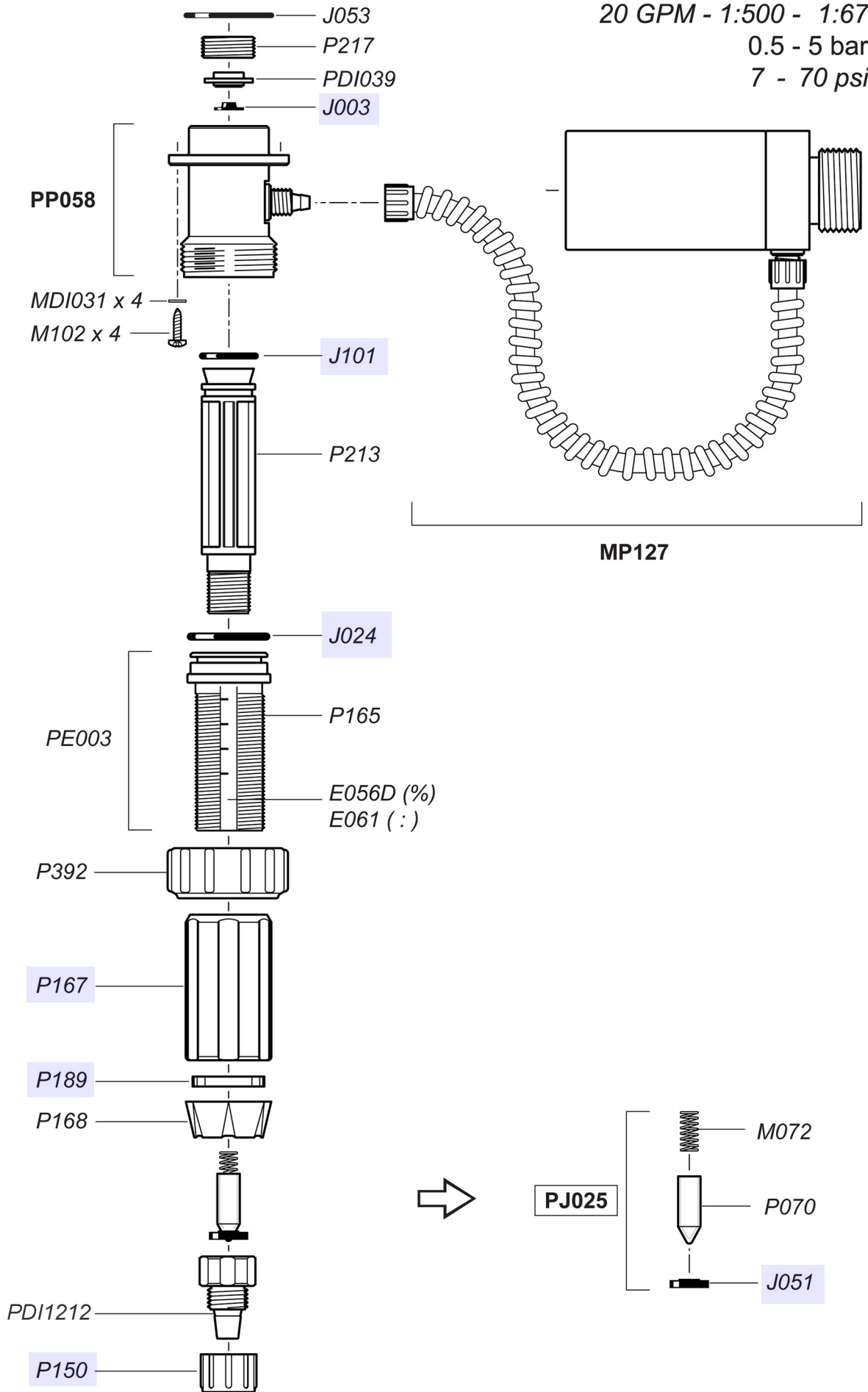

# D45RE1.5-IE

4.5 m<sup>3</sup>/h - 0.2 - 1.5%  
20 GPM - 1:500 - 1:67  
0.5 - 5 bar  
7 - 70 psi

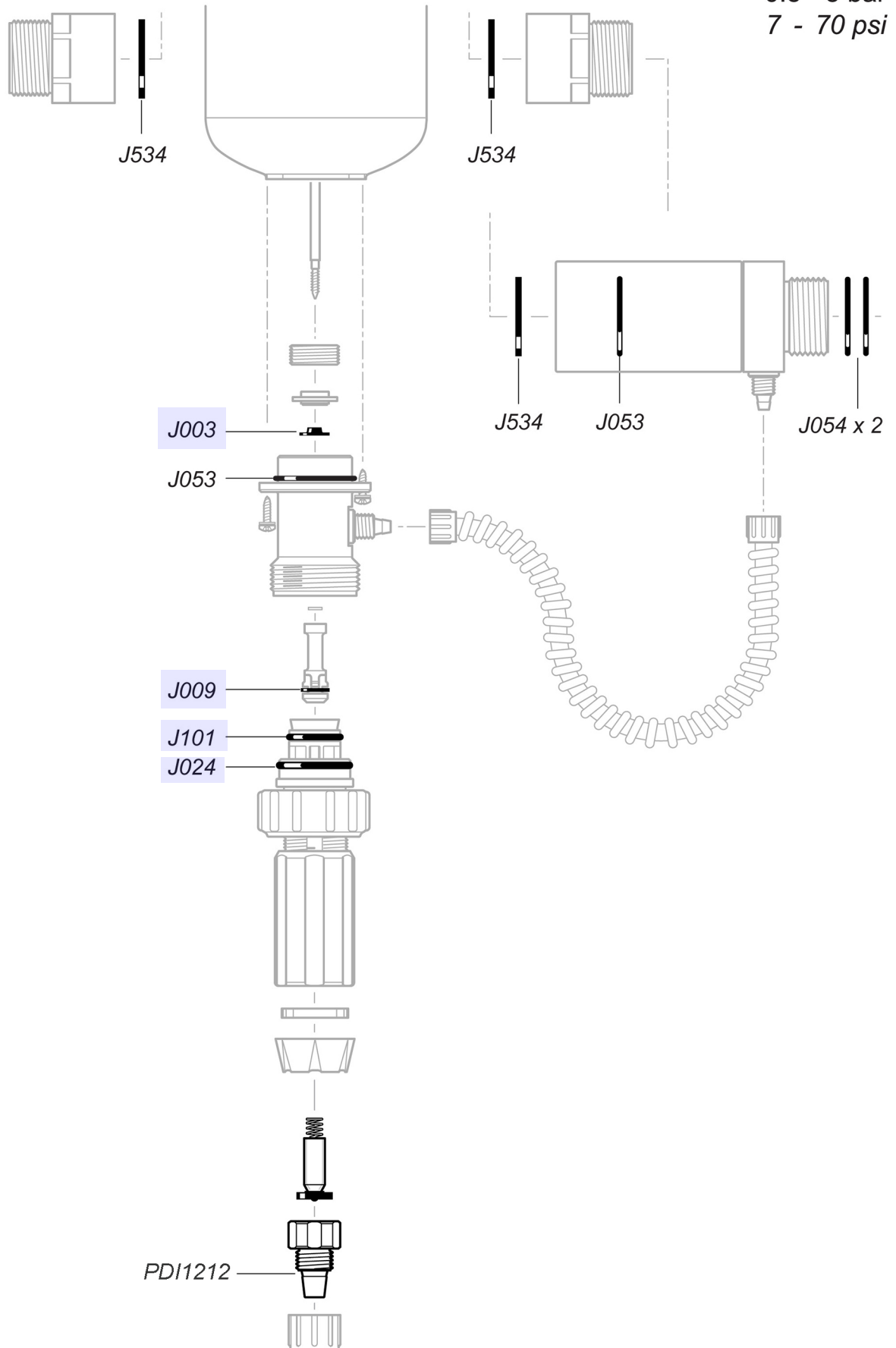

# D45RE1.5-IE

4.5 m<sup>3</sup>/h - 0.2 - 1.5%  
20 GPM - 1:500 - 1:67  
0.5 - 5 bar  
7 - 70 psi

